

FLOATING WETLAND



No.16, Jalan Korporat 5/KU9,
Off Persiaran Hamzah Alang,
Taman Perindustrian Meru,
42200 Klang, Selangor.

T: 603-3393 3622 F: 603-3393 3772

Email : superfloatsmalaysia@gmail.com

Website: www.superfloats.com

FLOATING WETLAND

City Garden Solitaire with walkway (CGS)

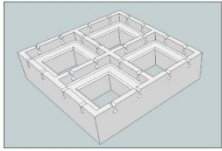

TYPICAL WETLAND MODULE

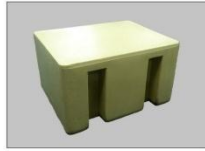

TYPICAL FLOAT UNIT

FLOATING WETLAND MODULE PROPERTIES

MODEL	FWM-120S
DIMENSIONS	1.2M (length) x 1.2M (width) x 0.3M (depth)
LOAD BEARING CAPACITY	50-100 KG/M ²
BOUYANCY CAPACITY	*VARIES*
COLOUR	BLACK OR AS SPECIFIED
MATERIALS	M.D.P.E.
INFILL	P.U.
STRUCTURAL GRID	6MM - 10MM
MOORING METHOD	ELASTIC MOORING WITH CONCRETE SINKER

* ALL DETAILS, INDICATIVES, DIMENSIONS, SIZES & QUANTITIES ARE SUBJECT TO MINOR ADJUSTMENT TO SUIT.

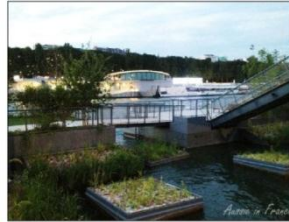
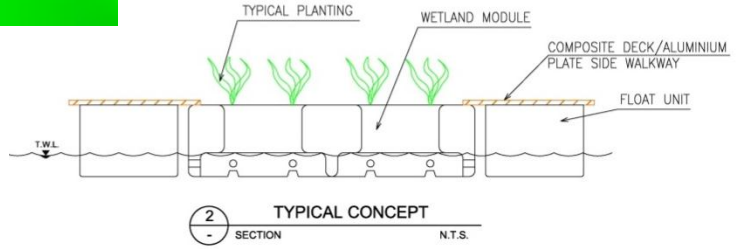

TYPICAL ARRANGEMENT

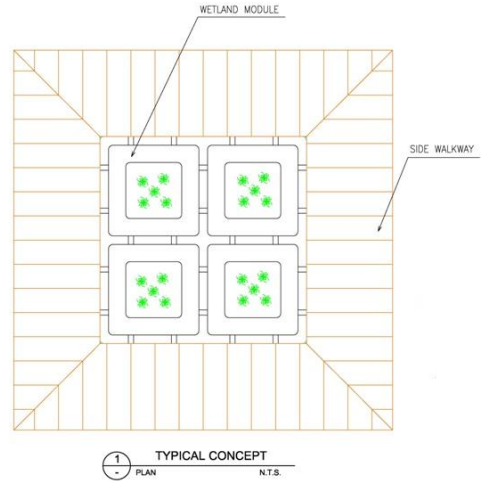

City Garden Linear (CGL)

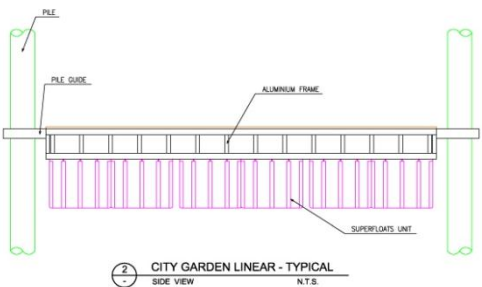
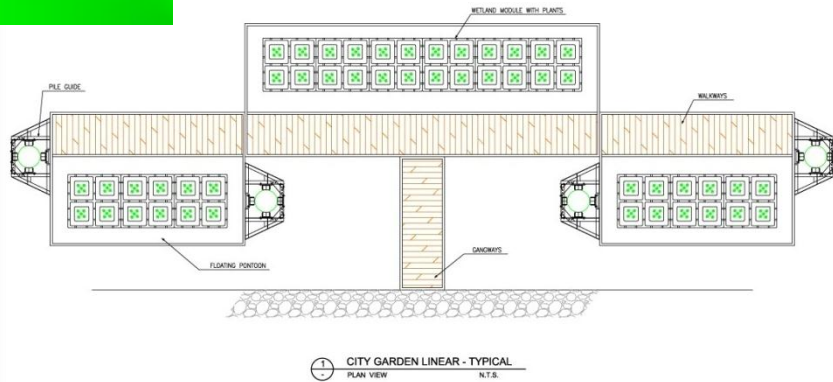

Superfloats EMS, Extendable Mooring Systems is unique such that the rubber elastic rods will stretch and extend its length, thus enable the floating platform i.e. pontoons or boats to rise or fall in tandem with the tides or waves.



TYPICAL PILE GUIDE



TYPICAL PILE

FLOATING WETLAND MODULE PROPERTIES

MODEL	FWM-120S
DIMENSIONS	1.2M (length) x 1.2M (width) x 0.3M (depth)
LOAD BEARING CAPACITY	50-100 KG/M ²
BOUYANCY CAPACITY	*VARIES*
COLOUR	BLACK OR AS SPECIFIED
MATERIALS	M.D.P.E.
INFILL	P.U.
MOORING METHOD	PILE / ELASTIC MOORING SYSTEM

* ALL DETAILS, INDICATIVES, DIMENSIONS, SIZES & QUANTITIES ARE SUBJECT TO MINOR ADJUSTMENT TO SUIT.

FLOATING WETLAND

City Wetland Linear (CWL)

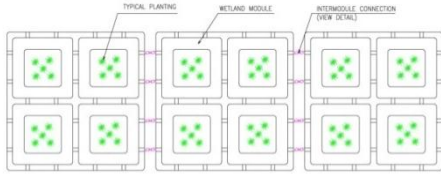

1 TYPICAL WETLAND MODULE PLAN
PLAN N.T.S.

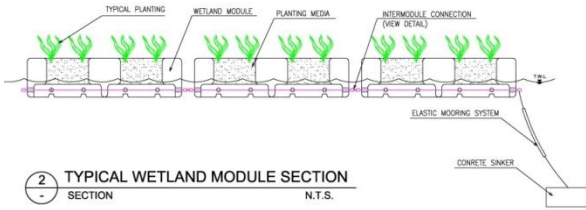

2 TYPICAL WETLAND MODULE SECTION
SECTION N.T.S.

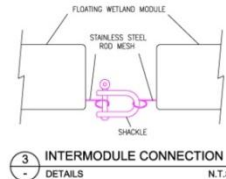

3 INTERMODULE CONNECTION
DETAILS N.T.S.



TYPICAL ARRANGEMENT



TYPICAL ARRANGEMENT



INTERMODULE CONNECTION

FLOATING WETLAND MODULE PROPERTIES

MODEL	FWM-120S
DIMENSIONS	1.2M (length) x 1.2M (width) x 0.3M (depth)
LOAD BEARING CAPACITY	50-100 KG/M ²
BOUYANCY CAPACITY	*VARIES*
COLOUR	BLACK OR AS SPECIFIED
MATERIALS	M.D.P.E.
INFILL	P.U.
MOORING METHOD	ELASTIC MOORING WITH CONCRETE SINKER

* ALL DETAILS, INDICATIVES, DIMENSIONS, SIZES & QUANTITIES ARE SUBJECT TO MINOR ADJUSTMENT TO SUIT.

City Garden Attache with Walkway (CGA FWM-120S) / CGA HX-250

FLOATING WETLAND MODULE PROPERTIES

MODEL	FWM-120S
DIMENSIONS	1.2M (length) x 1.2M (width) x 0.3M (depth)
LOAD BEARING CAPACITY	50-100 KG/M ²
BOUYANCY CAPACITY	*VARIES*
COLOUR	BLACK OR AS SPECIFIED
MATERIALS	M.D.P.E.
INFILL	P.U.
STRUCTURAL GRID	6MM - 10MM
MOORING METHOD	WALL ROLLER / SLIDER

CGA FWM-120A



Superfloats EMS, Extendable Mooring Systems is unique such that the rubber elastic rods will stretch and extend its length, thus enable the floating platform i.e. pontoons, buoys or boats to rise or fall in tandem with the tides or waves.

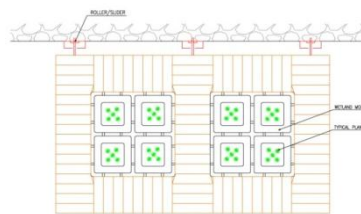

1 CITY GARDEN ATTACHE - TYPICAL FWM-120S
PLAN VIEW N.T.S.

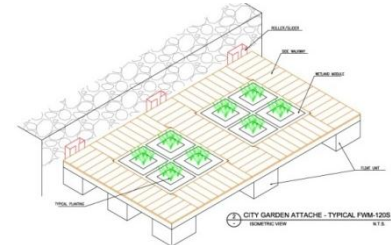

2 CITY GARDEN ATTACHE - TYPICAL FWM-120S
ISOMETRIC VIEW N.T.S.



WALL ROLLER / SLIDER

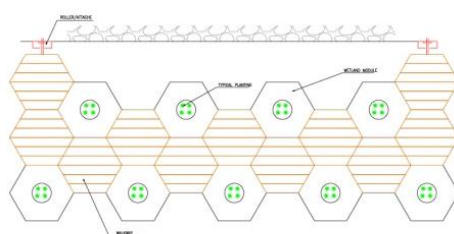
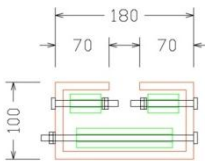

1 CITY GARDEN ATTACHE - TYPICAL HX-250
PLAN VIEW N.T.S.

FLOATING WETLAND MODULE PROPERTIES

MODEL	HX-250	HX-400
DIMENSIONS (LxWxD)	0.98M x 0.86M x 0.25M	0.98M x 0.86M x 0.4M
BOUYANCY	150 KG/M ²	300 KG/M ²
WEIGHT	16 KG	26 KG
COLOUR	BLACK OR AS SPECIFIED	BLACK OR AS SPECIFIED
MATERIALS	M.D.P.E.	M.D.P.E.
INFILL	P.U.	P.U.
MOORING METHOD	WALL SLIDER / ELASTIC MOORING SYSTEM	

* ALL DETAILS, INDICATIVES, DIMENSIONS, SIZES & QUANTITIES ARE SUBJECT TO MINOR ADJUSTMENT TO SUIT.

CGA HX-250

FLOATING WETLAND

Custom Garden – Oval (CGO)

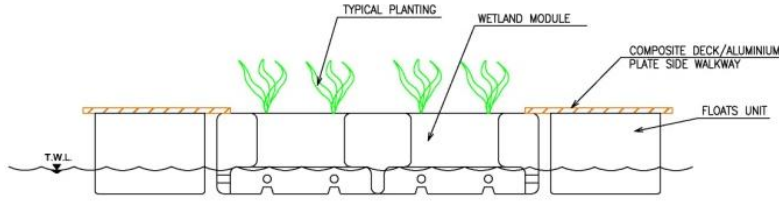

2 TYPICAL CONCEPT SECTION N.T.S.

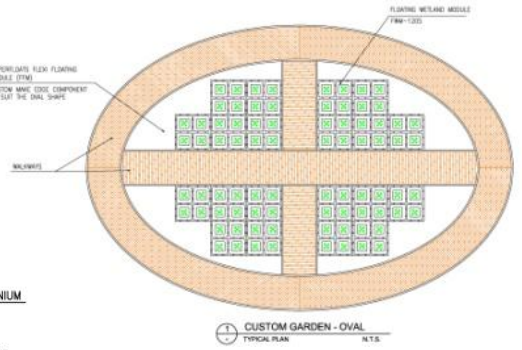

FLOATING WETLAND MODULE PROPERTIES

MODEL	FFM-120S
DIMENSIONS	1.2M (length) x 1.2M (width) x 0.3M (depth)
LOAD BEARING CAPACITY	50-100 KG/M ²
BOUYANCY CAPACITY	*VARIES*
COLOUR	BLACK OR AS SPECIFIED
MATERIALS	M.D.P.E.
INFILL	P.U.
STRUCTURAL GRID	6MM - 10MM
MOORING METHOD	PILE / ELASTIC MOORING SYSTEM

* ALL DETAILS, INDICATIVES, DIMENSIONS, SIZES & QUANTITIES ARE SUBJECT TO MINOR ADJUSTMENT TO SUIT.



TYPICAL PILE GUIDE



TYPICAL PILE



Superfloats EMS, Extendable Mooring Systems is unique such that the rubber elastic rods will stretch and extend its length, thus enable the floating platform i.e. pontoons, buoys or boats to rise or fall in tandem with the tides or waves.

City Wetland Shape (CWS)

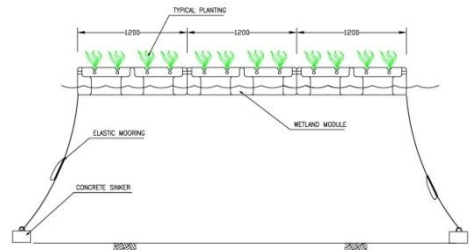

3 TYPICAL FLOATING WETLAND SECTION SCALE N.T.S.

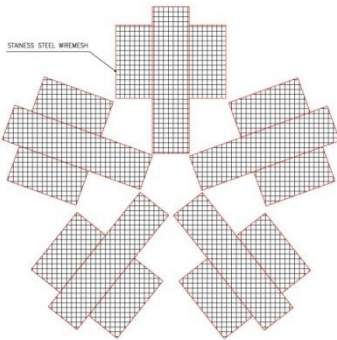

1 TYPICAL STAINLESS STEEL WIREMESH BASE PLAN N.T.S.

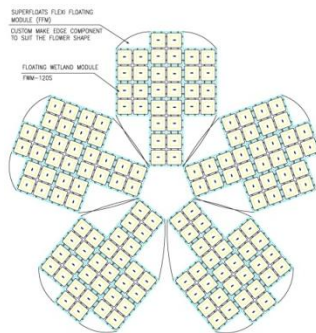

2 FLOATING WETLAND ISLAND PLAN N.T.S.

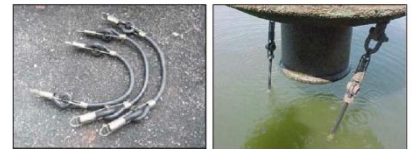

Superfloats EMS, Extendable Mooring Systems is unique such that the rubber elastic rods will stretch and extend its length, thus enable the floating platform i.e. pontoons, buoys or boats to rise or fall in tandem with the tides or waves.

FLOATING WETLAND MODULE PROPERTIES

MODEL	FFM-120S
DIMENSIONS	1.2M (length) x 1.2M (width) x 0.3M (depth)
LOAD BEARING CAPACITY	50-100 KG/M ²
BOUYANCY CAPACITY	*VARIES*
COLOUR	BLACK OR AS SPECIFIED
MATERIALS	M.D.P.E.
INFILL	P.U.
MOORING METHOD	ELASTIC MOORING WITH CONCRETE SINKER

* ALL DETAILS, INDICATIVES, DIMENSIONS, SIZES & QUANTITIES ARE SUBJECT TO MINOR ADJUSTMENT TO SUIT.